



JAMIE WARNER
— ESTATE AGENTS —



25 Dane Close, Kedington, Suffolk, CB9 7NX

Guide Price £340,000

- Three Bedrooms
- Conservatory
- Popular Village Location
- Sitting Room
- South Facing Garden
- Kitchen /Dining Room
- Views Over Open Fields

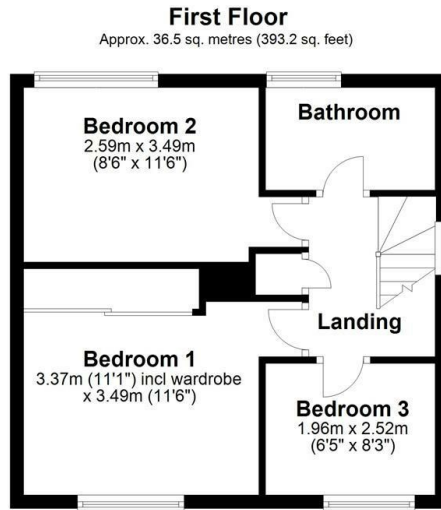
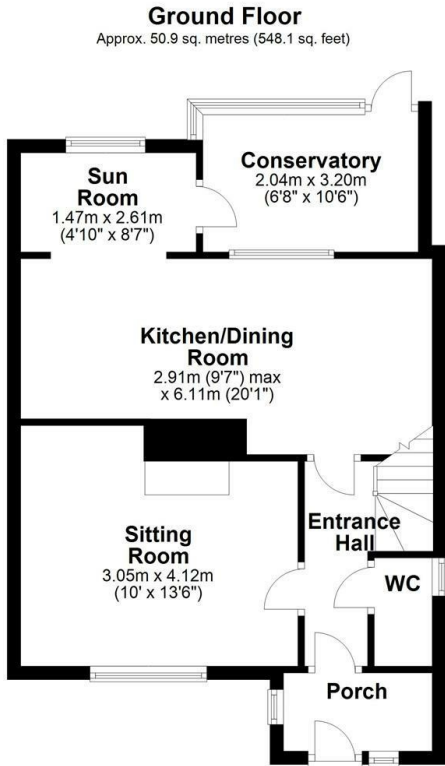

Total area: approx. 87.5 sq. metres (941.4 sq. feet)

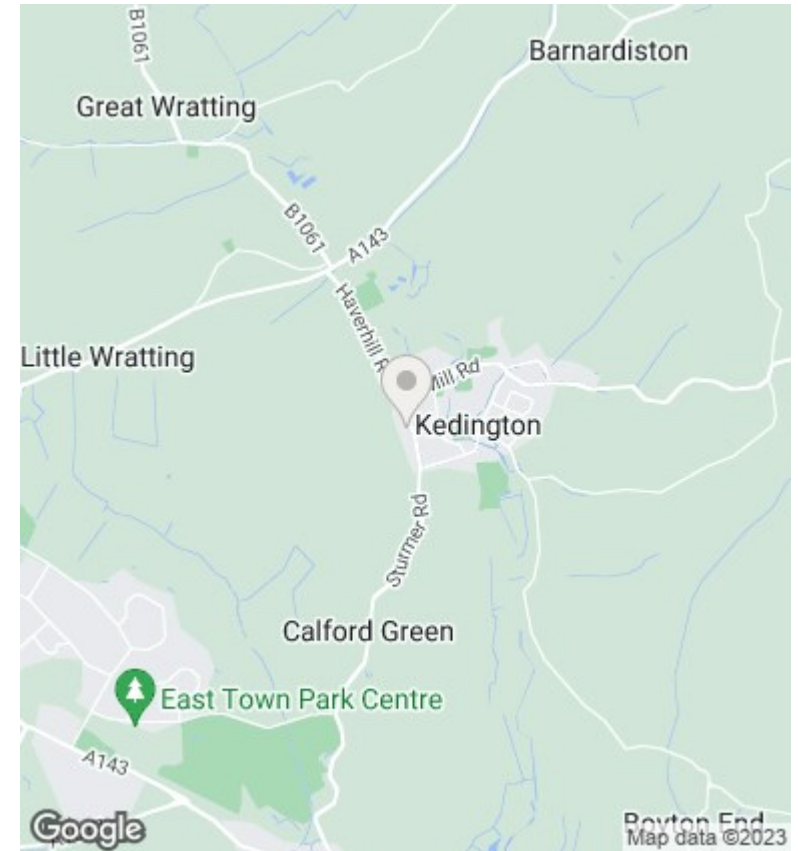

Directions

Viewings

Viewings by arrangement only. Call 01440 712221 to make an appointment.

Council Tax Band

EPC Rating:

Energy Efficiency Rating		Current	Potential
<i>Very energy efficient - lower running costs</i>			
(92 plus)	A		
(81-91)	B		
(69-80)	C		
(55-68)	D		
(39-54)	E		
(21-38)	F		
(1-20)	G		
<i>Not energy efficient - higher running costs</i>			
England & Wales		EU Directive 2002/91/EC	